

Courses up the Creek
 Beginning at an Elm
 N 50 E 16 1/4
 N 56 E 18 to a post
 34 1/4

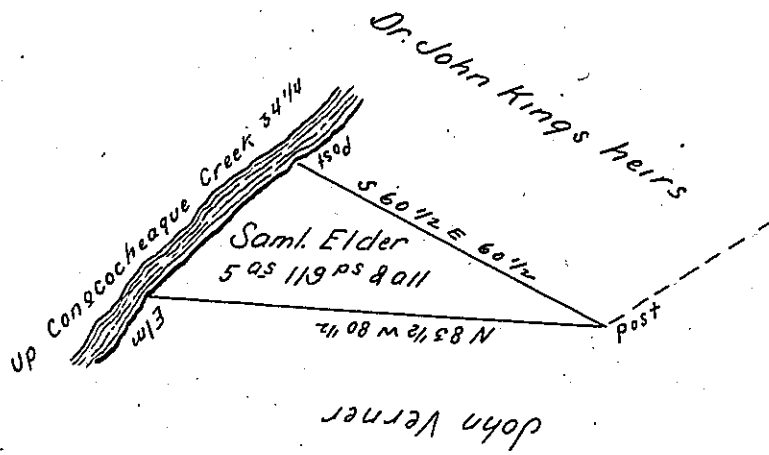

Draught of a Tract of Land Situate in Peters Township Franklin County Containing Five Acres and One hundred and nineteen perches and Allowance of Six p. Cent for Roads Surveyed the 21st day of October 1815 in pursuance of a Warra— Granted Samuel Elder for 6^{acs} bearing date the 13th day of August 1814.

*Jacob Spangler Esq^r } Arch^d Fleming D.S.
 Surveyor General of Penn^a }*

I do Certify that at the time of making the above Survey there was a part of the land cleared and Cultivated and a House thereon in which a family was actually residing.

H.F.

IN TESTIMONY that the above is a copy of the original remaining on file in the Department of Internal Affairs of Pennsylvania, made conformably to an Act of Assembly approved the 16th day of February, 1833, I have hereunto set my Hand and caused the Seal of said Department to be affixed at Harrisburg, this twenty third day of September 1904.

George D. Brown
 Secretary of Internal Affairs.